



Park Renovation Planning & Progress

Continuing an Inspirational Civic History

1988

MAJOR THEMES

Natural Image

Our neighborhood was built in the 1920s, in the craftsman style which uses natural materials like brick and stone and landscaping with native plants like hardwood trees, dogwoods, and azaleas. Our park should be the same.

Neighborhood Scale

Our park is small, a strip of lots where houses once stood. The land rolls gently and large-scale things won't fit. The park should be one step beyond the yards of our own houses, an extension of the places where we live.

Open to All

Our park is a city park. It should be open and easily visible from the street and sidewalk. It should not seem to be an enclave cut off and only for a few, but should invite any passerby to come and enjoy it.

The neighborhood survey we took in 1986 and the guidance of the Atlanta Parks System have been blended into this plan. We hope you like it.

Children's Playground

Our neighborhood has many families and a playscape was the most requested element. Facilities should be provided for toddlers, kindergartners, and elementary school-age children, and should reflect the natural image of the park.

Passive Uses

Our park is too small for large playfields like softball or soccer, or for use that would attract large crowds like a community swimming pool. Activities like jogging, picnics, kite flying, or just walking are the sorts of things that are suitable.

Maintenance

The Parks Department insists that the park be easy to maintain. Features like ponds or reflecting pools or beds of annual flowers require intensive work. Paved paths will control erosion where traffic keeps the grass from growing.

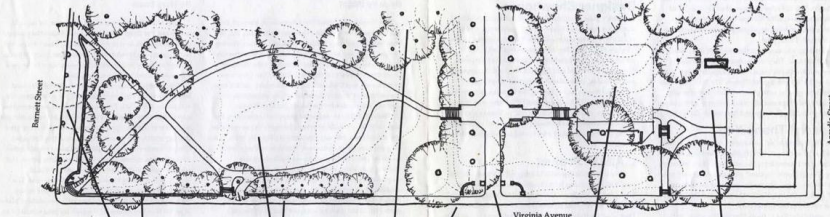

Save Big Trees at Barnett

Move the sidewalk west so that these magnificent oaks will have room for roots and not damage the sidewalk.

Rebuild Walls at Virginia

Re-work and repair so that the current three walls of former houses become one element. Replace crumbling steps with safe stone stairway.

Provide Natural Village Green

Make the main area open grass for free open use like frisbee, running, dogs, or sunbathing.

Repair Sidewalks

We hope that all of Virginia from Midtown Perimeter to the Virginia Highland shops will become a pleasant pedestrian way.

Buffer Nearby Houses

Retain existing shade trees, adding dogwoods and evergreen shrubs to provide a background when viewed from Virginia Avenue.

Close DeLeon Street

Remove traffic through the park and link the two halves with a small plaza. Retain the existing trees.

Build Gates

How could we have a park without gates like the ones on St. Charles and St. Augustin? They are granite and wrought iron and lend a sense of prominence to the entrance to these streets.

Provide Playscape

We want a nice big play area like the one at Osnee Park, with timber beams and a big wood chip pit. Benches and a shade arbor will let adults enjoy it as much as the kids.

Complete Volleyball Area

Volleyball is an intensive use but just small enough to work in this park. Permanent restrooms are needed and soccer fences. The neighborhood volleyball league will do this part.

DESIGN DETAILS

1991

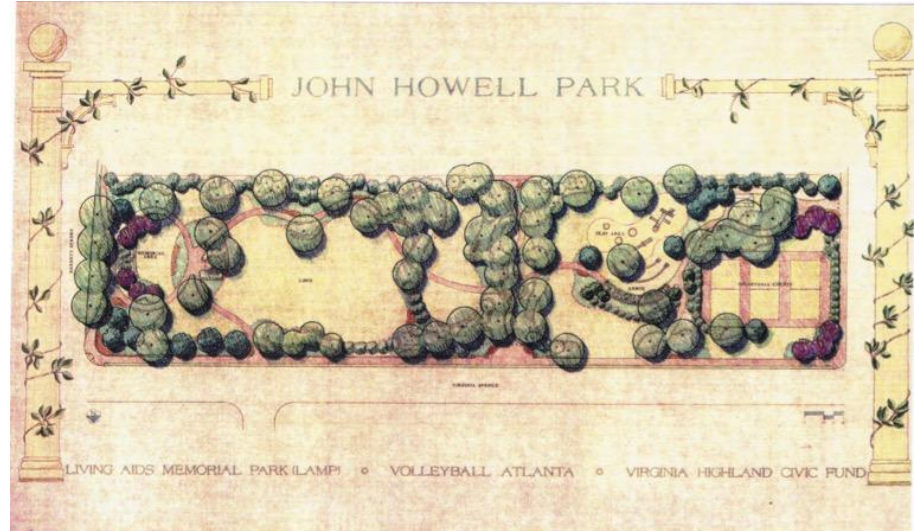

Path to the Playground

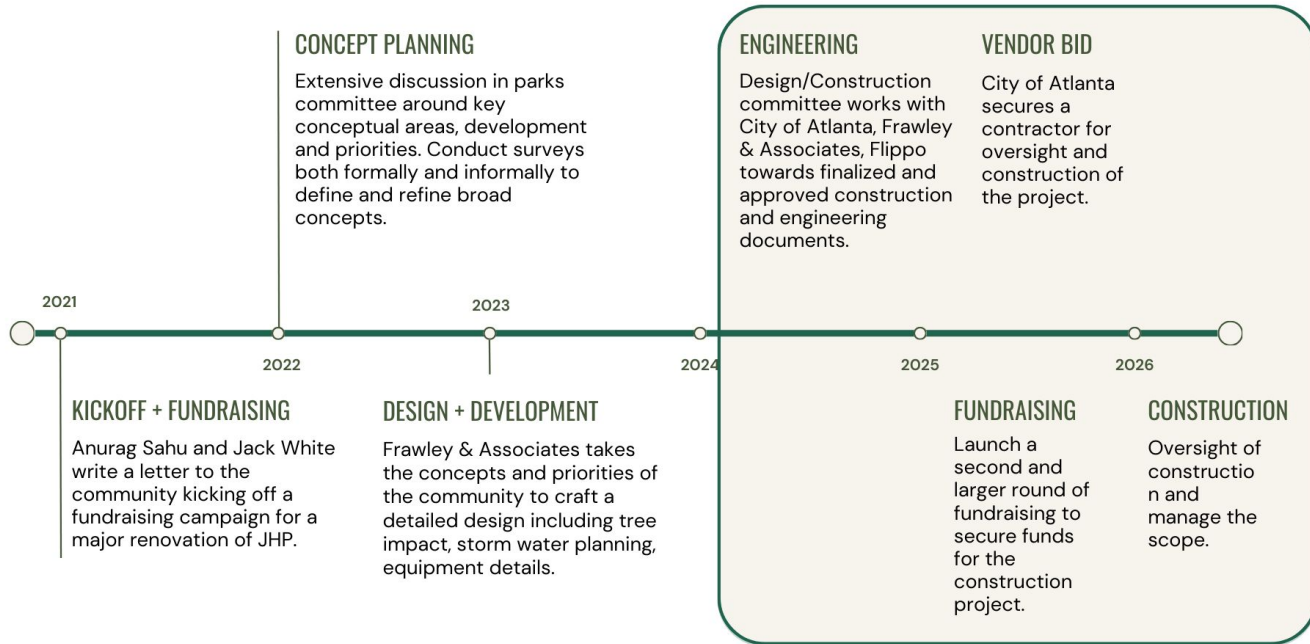

What we've heard from you

Survey 1 Results (2022)

“We love...”

- Virginia-Highland
- Green space
- Play
- Dog walks
- Festivals
- A walk amongst the trees
- Community
- Kids classes at the oval
- Picnics
- Getting together
- Classroom meet-ups at the playground

Survey 1 Results (2022)

DO

- ✓ Revitalize the great lawn
- ✓ Upgrade playground with equipment styles that compliment the park and serve multiple ages
- ✓ Address homelessness
- ✓ Consider ADA accessibility

DON'T

- ✗ Disrupt the balance between passive and active use
- ✗ Forget budget for long-term clean-up and maintenance
- ✗ No pickleball!

Renovation Priorities

1	Rainwater issues	<ul style="list-style-type: none">• Stormwater issues are the primary driver of the renovation and must be fixed per City of Atlanta• Requires the playground to be removed
2	The Great Lawn	<ul style="list-style-type: none">• Revitalize into a lush lawn• Maintain the size• Do not grade it to be level; work with APS to maintain flat field access
3	New Playground	<ul style="list-style-type: none">• Offset lost playground equipment with new playground layout, new pieces and ground cover• Choose styles that compliment the park and serve multiple ages
4	Improve and maintain existing assets	<ul style="list-style-type: none">• Tree survey and integration of results into project design• Fix water lines to the water fountain, benches, fence posts, signs, etc• Install new surface in the Oval
5	Activation through fields, courts, etc	<ul style="list-style-type: none">• No changes to the volleyball courts• Pickleball won't fit with the terrain given elevation changes. It also would disrupt the balance of active and passive uses in the park.

West



ADVENTURE ZONE

LITTLES ZONE



THE OVERLOOK

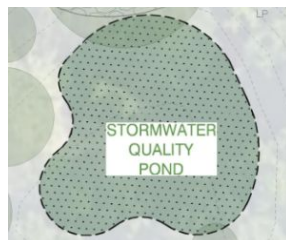

FUTURE ADVENTURE ZONE

East



THE OVAL - SYNTHETIC LAWN



GREAT LAWN RESTORATION

THE GREAT LAWN & THE OVAL



NEIGHBORHOOD INFO KIOSK



ADA ROUTE SIGNAGE

SITE FURNISHINGS

Hill Zone



HILL ZONE

Next Steps

- **Civil Engineering Underway**
 - More specific pricing enabled by this technical look at the grading needed around the playground areas
- **Formalize Friends of JHP**
 - Committee has been reviewing how to raise funds in a way that minimizes costs and volunteer time while maximizing donor value

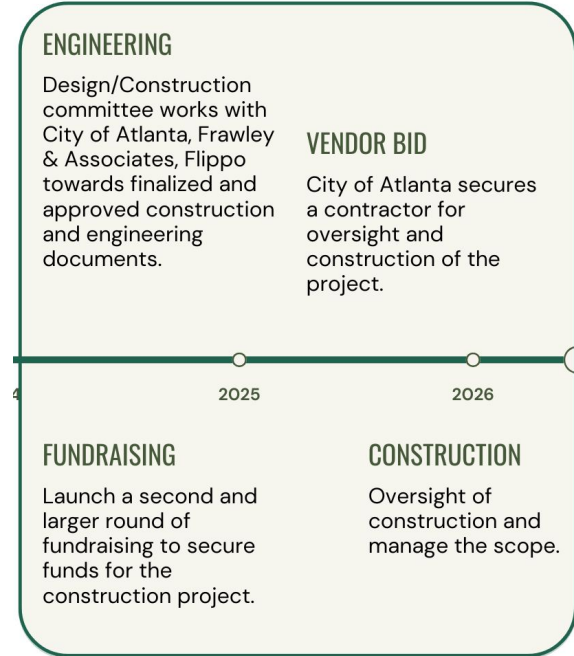

Fundraising Update

Total Project Budget

- New Playground equipment and surfaces (~\$700k)
- Rain gardens, grading, and stormwater management (~\$300k)*
- Great Lawn restoration and Barnett Oval revitalization (~\$250k)
- Hardscapes - steps, brick sidewalks, ADA ramps, fencing and more (~\$250k)
- New plantings and existing tree management (~\$100k)
- Professional services (~\$50k)

Preliminary Cost Estimate: \$1.5-\$1.75M

Sources of Funding: Planning & Phase 1

\$950K TOTAL PHASE 1 (WEST)

Funding Plan:

\$300K - City of Atlanta, Moving Atlanta Forward Bond

\$100K - Public Grant, Park Pride

\$106K - 2022 - 2024 Neighborhood Donations

\$444K - New Community Funding Needed

Get Involved!

JHP Needs You!



1. **Donate**
2. **Join** our fundraising team
3. **Walk** the park on a JHP Tour
4. **Spread** the word
5. **Learn** more at friendsofjohnhowellpark.org

Why support JHP?

- Our neighborhood deserves a shared green space that reflects the vitality of our neighborhood!

- **Community Vitality**
- **Property Value**
- **Health & Wellness**
- **Clean Water**

What about public safety enhancements?

- VHCA is already working with the City Parks & Rec Dept to address litter and loitering issues
 - A busy park is a safe park!!
- **Councilman Alex Wan**
 - **Zone 6 Police Precinct**
 - **VaHi Security Patrol**
 - **Atlanta 311**

Donate and become part of the legacy of JHP...

- We are considering naming rights for different elements of the park
- Explore the plans tonight!

- **Playground**
- **Tables**
- **Trees**
- **Bricks**
- **More!!**

What Next?

- Learn more at www.friendsofjohnhowellpark.org
- Email our volunteers at friendsofjohnhowellpark@gmail.com